

**PROFILE VIEW**

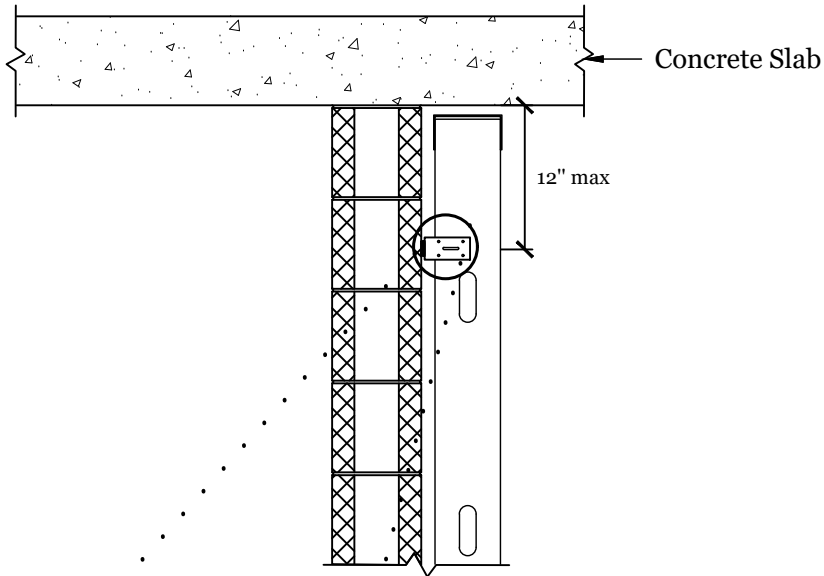

**FRONT VIEW**

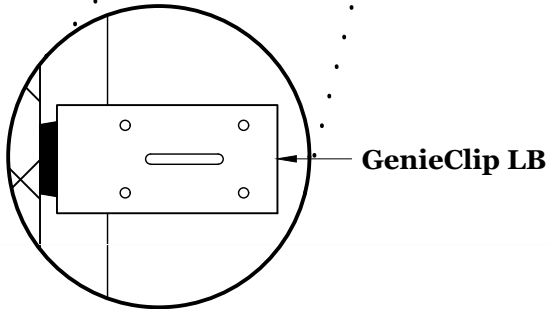
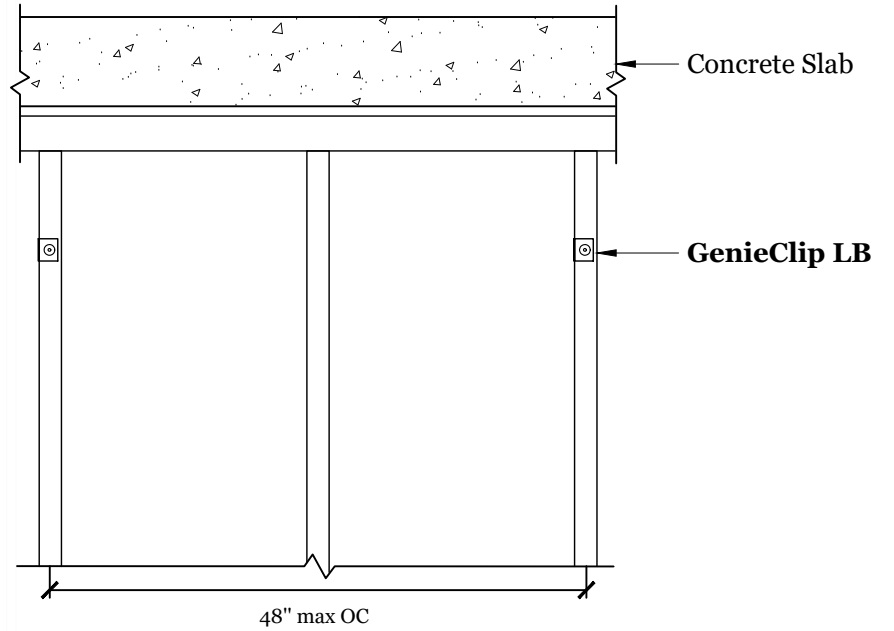

Phone: (416) 449 - 0049  
 Fax: (416) 849 - 0415  
 131 Royal Group Crescent  
 Vaughan, ON L4H 1X9  
 Canada

**GENERAL NOTES:**

The information provided in this drawing is accurate to the best of our knowledge at the time of printing. However, we reserve the right to make changes when necessary without notification.  
 © Pliteq Inc. 2017.

Notes

PROJECT: <b>GenieClip® LB</b> Wall Series	
DRAWING: Wall to Wall Isolated Partition	
DRAWN BY: J. Joo	
DATE: 2017-01-13	DWG. NO.: LB03
SCALE: N/A	